

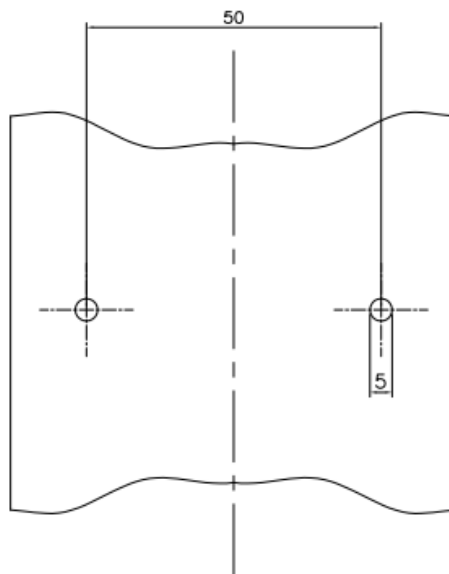

TYRE SPECIFICATIONS

2021-2025 AUSTRALIAN KARTING ASSOCIATION LTD. (Karting Australia)

<i>Tyre Manufacturer</i>	CHENG SHIN RUBBER ID. Co., LTD
<i>Tyre Supplier</i>	ST GEORGE KART CENTRE W/SALE PTY LTD
<i>Make</i>	MAXXIS
<i>Model</i>	M190D 10x4.00-5
<i>Competition Group / Class/es</i>	GROUP 1A – CADET9, CADET12
<i>Number of pages</i>	4
<i>Number of appended pages</i>	



TREAD DESIGN DRAWING

TECHNICAL DESCRIPTIONS



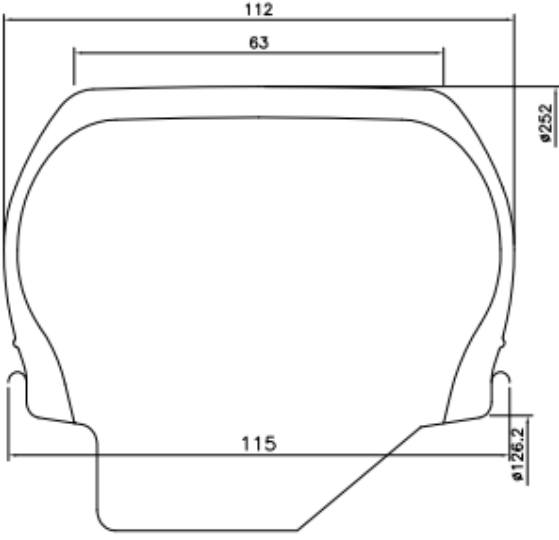

At a temperature of 23°C +/- 2°C and with a humidity of 50% +/-5%

Pt	Descriptions	Value		Tolerances
1	<i>Dimensions</i>	10X4.00-5		-
2	<i>Tread compound designation</i>	M190D		-
3	<i>Service pressure</i>	1.0 bar		+/- 0,3 bar
4	<i>Maximum inflation pressure</i>	4 bar		Max
5	<i>Recommended Inflation pressure</i>	0.6 bar		
6	<i>Maximum load capacity</i>	90 kg		Max
7	<i>Maximum speed</i>	200 km/hr		Max
8	<i>Depth of tread</i>	3.7		+/- 0,5 mm
9	<i>Weight in grams</i>	940		+/- 10 %
10	<i>Numbers of ply</i>	2		-
11	<i>Tread thickness</i>	4		+/- 1,0 mm
12	<i>Number of tread wear indicators</i>	6		-
13	<i>Carcass material</i>	Polyester		-
14	<i>Angle of tyre canvass</i>	31°		+/- 3°
15	<i>Canvass thread type (According to ISO)</i>	1500D/2		-
16	<i>Tubeless tyre</i>	YES		-
17	<i>Superficial tread hardness (ISO 48 :2010 – 2 samples of 2mm thickness)</i>	60°		+/- 5 DIDC - IRHD
18	<i>Shore hardness</i>	65		+/- 5
19	<i>IRHD hardness</i>	68		+/- 5
20	<i>Classification (According to ISO 37:2005 – 300%) (DELETE OR ADJUST THOSE NOT APPROPRIATE)</i>		MEDIUM	HARD

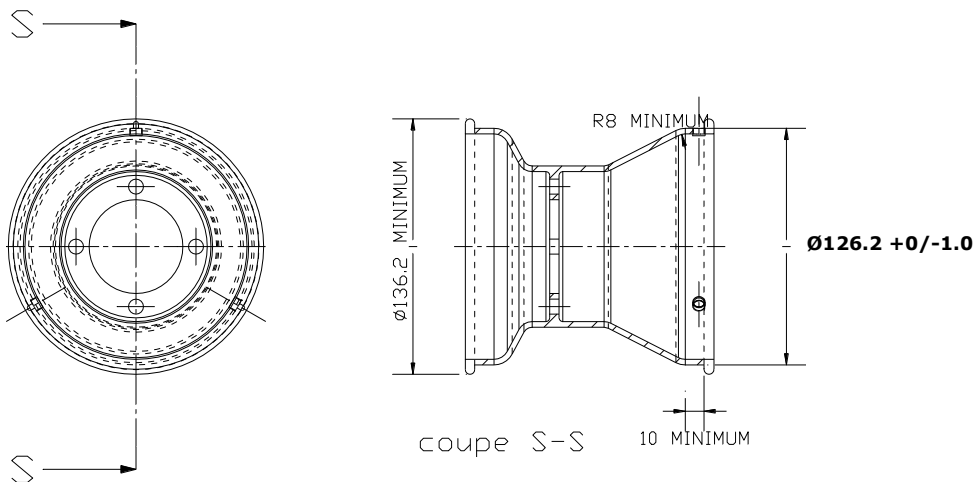
B	DRAWING OF CROSS SECTION AND DIMENSIONS OF TYRE FITTED TO A RIM	
		
Tolerances		
	Ø 252	+/- 7
	112	+/- 5
	Ø 126.2 *	+/- 1
	115	+/- 3
	63	+/- 5
Comments		

Standardised 5" rim



C	PHOTOS AND INSCRIPTIONS	<i>Only inscriptions which will not change during production are mentioned below.</i>		
<i>Photo of tyre external side wall</i>		<i>Inscriptions on tyre external side wall</i>		
		<i>Text</i>	<i>Height</i>	<i>Stroke</i>
		10x4.00-5	10mm	4-6mm
		Mold No.	3.5mm	0.5mm
		FOR RACING PURPOSE ONLY MAX. INFLATION PRESSURE 4.0KG/CM ²	4mm	0.5mm
		MAXXIS	9.5mm	4-7mm
MAXXIS Cadet-KA (print)	23mm	2.5-5mm		
<i>Photo of tyre internal side wall</i>		<i>Inscriptions on tyre internal side wall</i>		
		<i>Text</i>	<i>Height</i>	<i>Stroke</i>
		10x4.00-5	10mm	4-6.5mm
		Mold No.	3mm	0.5mm
		S.L	5mm	3mm
		MAXXIS Cadet-KA (print)	23mm	2.5-5mm
		TUBELESS	4mm	0.5mm
		MADE IN TAIWAN	3mm	0.5mm
			14mm	1.5-4mm
			12mm	0.25mm
	10mm	2mm		



TYRE SPECIFICATIONS

2021-2025 AUSTRALIAN KARTING ASSOCIATION LTD. (Karting Australia)

<i>Tyre Manufacturer</i>	CHENG SHIN RUBBER ID. Co., LTD
<i>Tyre Supplier</i>	ST GEORGE KART CENTRE W/SALE PTY LTD
<i>Make</i>	MAXXIS
<i>Model</i>	M190D 11x5.00-5
<i>Competition Group / Class/es</i>	GROUP 1A – CADET9, CADET12
<i>Number of pages</i>	4
<i>Number of appended pages</i>	

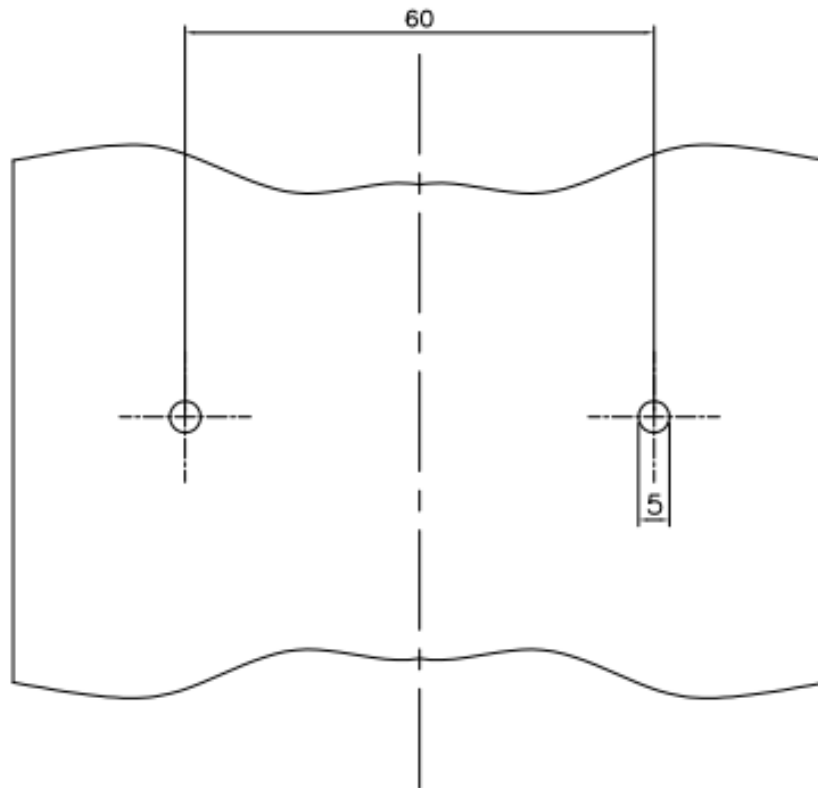

TREAD DESIGN DRAWING

TECHNICAL DESCRIPTIONS

At a temperature of 23°C +/- 2°C and with a humidity of 50% +/-5%

Pt	Descriptions	Value		Tolerances
1	Dimensions	11X5.00-5		-
2	Tread compound designation	M190D		-
3	Service pressure	1.0 bar		+/- 0,3 bar
4	Maximum inflation pressure	4 bar		Max
5	Recommended Inflation pressure	0.6 bar		
6	Maximum load capacity	90 kg		Max
7	Maximum speed	200 km/hr		Max
8	Depth of tread	3.7		+/- 0,5 mm
9	Weight in grams	1280		+/- 10 %
10	Numbers of ply	2		-
11	Tread thickness	5		+/- 1,0 mm
12	Number of tread wear indicators	6		-
13	Carcass material	Polyester		-
14	Angle of tyre canvass	31°		+/- 3°
15	Canvass thread type (According to ISO)	1500D/2		-
16	Tubeless tyre	YES		-
17	Superficial tread hardness (ISO 48 :2010 – 2 samples of 2mm thickness)	60°		+/- 5 DIDC - IRHD
18	Shore hardness	65		+/- 5
19	IRHD hardness			+/- 5
20	Classification (According to ISO 37:2005 – 300%) (DELETE OR ADJUST THOSE NOT APPROPRIATE)		MEDIUM	HARD

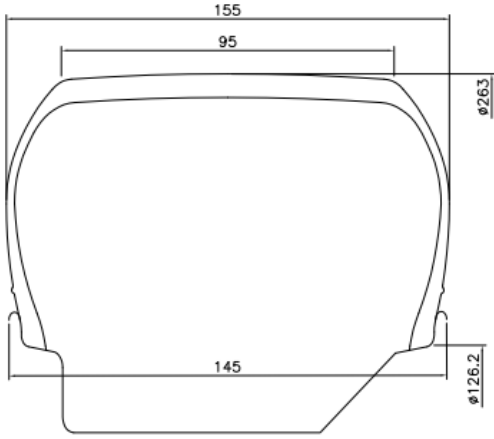
B	DRAWING OF CROSS SECTION AND DIMENSIONS OF TYRE FITTED TO A RIM		
		Tolerances	
		Ø 263	+/- 7
		155	+/- 5
		Ø 126.2 *	+/- 1
		145	+/- 3
		95	+/- 5
		Comments	

Standardised 5" rim

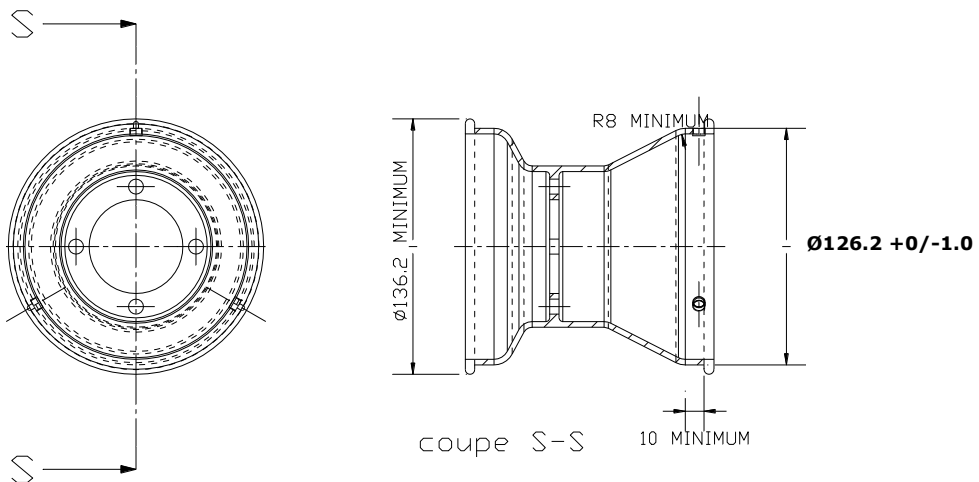

C	PHOTOS AND INSCRIPTIONS	<i>Only inscriptions which will not change during production are mentioned below.</i>		
<i>Photo of tyre external side wall</i>		<i>Inscriptions on tyre external side wall</i>		
		<i>Text</i>	<i>Height</i>	<i>Stroke</i>
		11x5.00-5	10mm	4-6.5mm
		Mold No.	3mm	0.5mm
		FOR RACING PURPOSE ONLY MAX. INFLATION PRESSURE 4.0KG/CM ²	4mm	0.5mm
		MAXXIS	9.5mm	4-7mm
		MAXXIS Cadet-KA (print)	23mm	2.5-5mm
ROOKIE	5mm	2.5mm		
<i>Photo of tyre internal side wall</i>		<i>Inscriptions on tyre internal side wall</i>		
		<i>Text</i>	<i>Height</i>	<i>Stroke</i>
		11x5.00-5	10mm	4-6.5mm
		Mold No.	3mm	0.5mm
		S.L	5mm	3mm
		MADE IN TAIWAN	3mm	0.5mm
		TUBELESS	4mm	0.5mm
		MAXXIS Cadet-KA (print)	23mm	2.5-5mm
		TUBELESS	14mm	1.5-4mm
			14mm	1.5-4mm
			12mm	0.25mm
	10mm	2mm		